



Made in Taiwan
Handles

Material

Zn : Zinc (zamak)

Al : extruded Aluminum, die-casted Aluminum

Cu : Brass

St : steel, carbon steel

SUS: stainless steel

POM

How to read

396 I Zn >> 396 : item number, Zn : Material
40,64, >> size in mm without [], inch with [1],
for handles usually means
size between central hole and central hole

862 I Zn >> 862 : item number, Zn : Material
D16xH21 >> D : diameter, H : Height

Plated colors

C : chrome plating (polished chrome)

DC : matchrome

SC : Satin chrome

BRC : brushed chrome

N : nickel plating (polished nickel)

NBR : nickel brushed

DN : mat nickel

SN : satin nickel

B : black nickel

AB : antique bronze brushed

AE : antique brass brushed

Coated colors

W : white

BM : black

S : silver

AL : almond

GRE : grey

Anodized colors

We provide custom-made colors no matter on plating or coating.

Contact us if you need special colors.

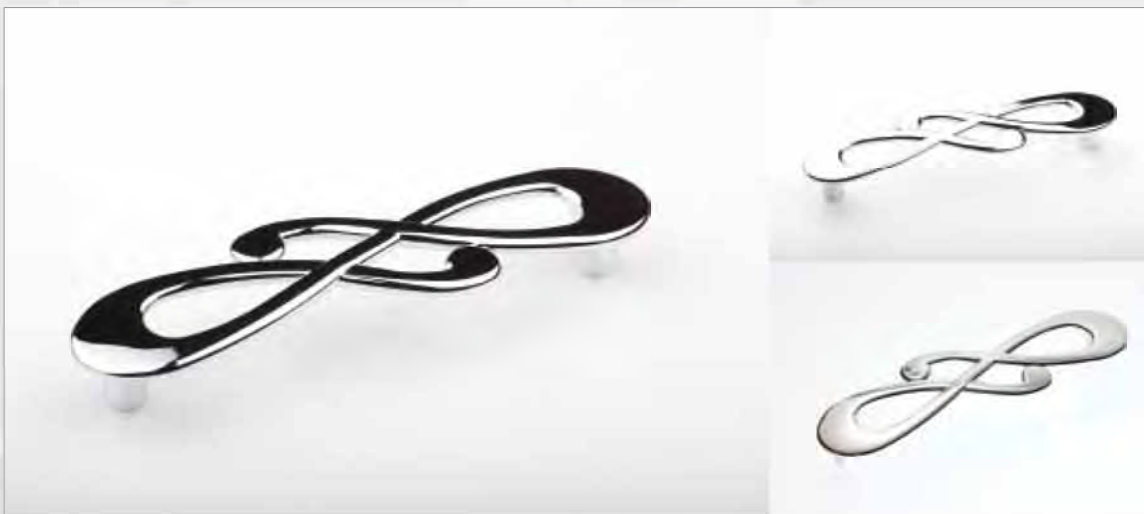

55531zn
96 mrnc. c.



55561zn
64 mmc. c.



55571zn
160 mmc. c.

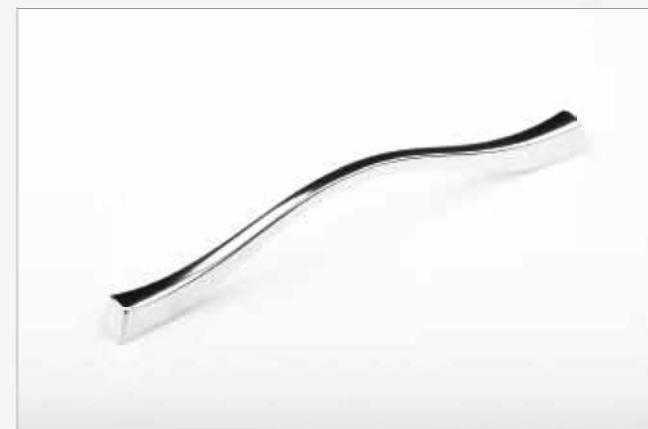

55591zn
128 mmc. c.

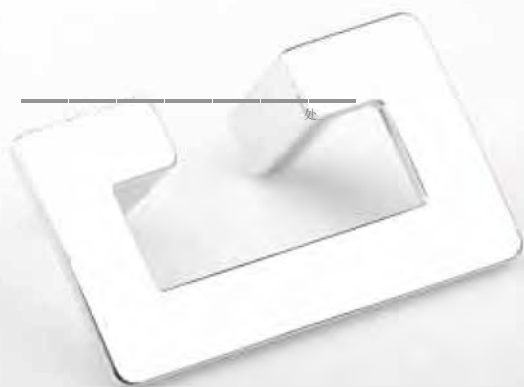

ssa|zn
32 mmc. c.



5560|zn
32 mmc. c.



278 | Zn leg+ Al bar

128, 160, 192, 224, 256, 480,
672, 896, 960, 992 mmc. c.



438 | Zn + Al

96, 128mmc. c.
4" c. c.

573 | Zn + Al

96, 128, 160,
192, 224,
120, 200, 230,
300, 320,
348, 448mmc. c.





5546 I ZN
192mmc. c.



5547 I Zn
120mmc. c.



#335 (B=10) / 412 (B=12 mm)

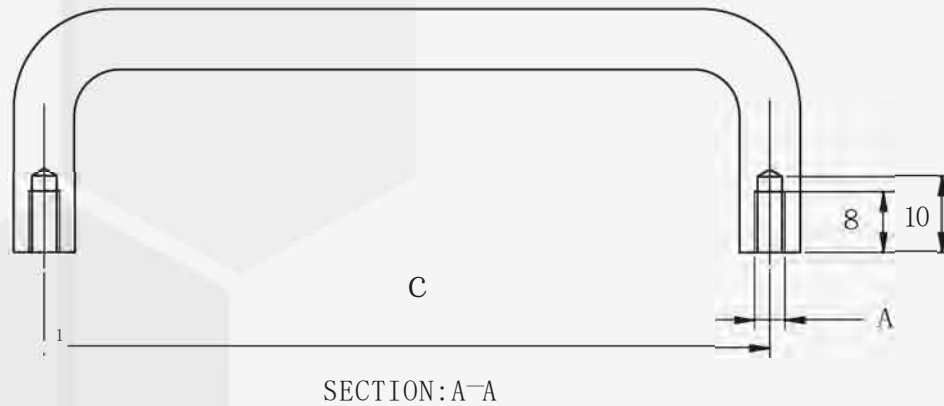

D

Material	CC.	Height	Grip Dia	Thread
	(C)	(D)	(B)	(A)
Aluminum Brass Steel Stainless Steel	64 mm	32 mm	10 mm	M4 or M5
	96 mm	32 mm		
	128 mm	32 mm		
	160 mm	32 mm		
	192 mm	35 mm		
	224 mm	35 mm		
	256 mm	35 mm	12 mm	8-32 or 6-32
	3'	32 mm		
	4'	32 mm		
	5'	32 mm		
	6'	32 mm		
	7'	35 mm		
	8'	35 mm		
	10'	35 mm		



please specify your material, thread, diameter(B), C.C.(C), and height(D).
Custom-made sizes are also available.



220SIA1

116mm c. c. / L134mm / H53mm

164mm c. c. / L182mm / H57mm

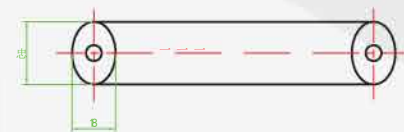
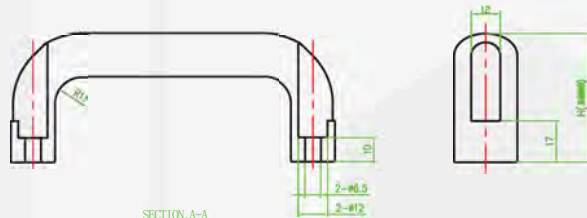



2211IA1
135 mmc. c.



55191zn
127 mmc. c.



228 | Al
102 mmc.c.



591 | Zn
96,128 mmc.c.



2371A1
64, 96, 120, 128, 160, 192
224, 256, 288, 320 mmc. c.



2431A1
128, 224 mmc. c.



3310 | SUS304

20mm c. c. / L35mm
80mm c. c. / L100mm
180mm c. c. / L200mm
280mm c. c. / L300mm



913 | Cu

1" c. c.



5549 | Zn

96mm c. c.



701 knob I Cu
 D17xH27 ring 022mm
 D20xH27 ring 028mm
 D25xH32 ring 032mm

见



348 handle I Cu, Acrylic
 96 mmc. c.
 3", 3-1/2" c. c.

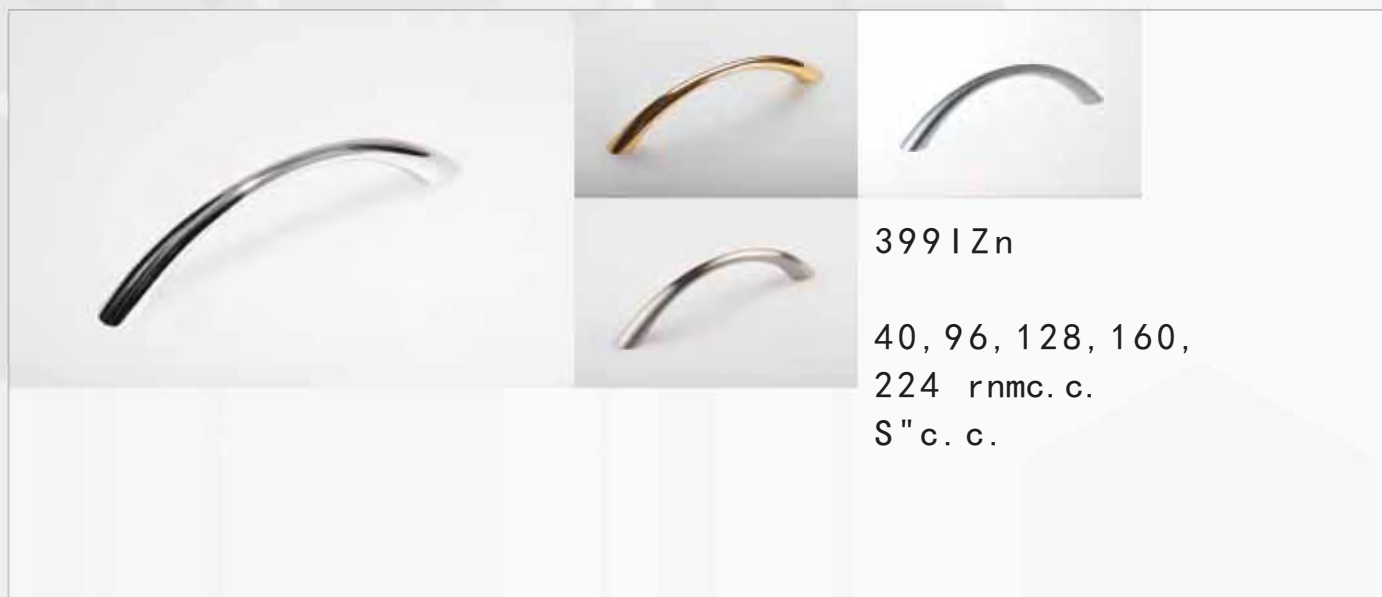

404 | Zn

96 mmc. c.
4-1/2" c. c.



429 round ends, 466 flat ends IS七, SUS, Cu, Al

96, 128, 160, 192, 224, 256, 320, 384,
480, 220 mm c. c.



418 | cu, zn

96, 128 mm c. c.



439IZn

96, 128mmc. c.



s101zn

64, 96mmc. c.



513IZn

64, 96mmc. c.



453 | Zn
64, 96, 128, 160mm c. c.



515 | Zn
60, 96, 128mm c. c.



455 | Zn
64, 96mm c. c.





503 | zn
96 mmc. c.



598 | zn
64, 96, 128, 192 mmc. c.



568IZn
96mrnc. c.



518IZn
96, 128mmc. c.



525IZn
128mmc. c.



5411Zn

64mmc. c.



5691Zn

105mmc. c.



55211Zn

96mmc. c.



543IZn

64, 96, 128, 160, 240, 288
mm. c. c.



5241Zn

64, 96, 128, 160
mm. c. c.



5530 | zn
40 mmc. c.



~
S
&
)
S
a
f
b
W
"
W
"



~
S
&
)
S
a
a
W
"
W
"



559 IZn

30, 60,
120mm c. c.



945 IZn

32, 96, 128mm c. c.



5771Zn

120mmc. c.



5781Zn

96mmc. c.



5811Zn

128, 288mmc. c.



588 I Zn

160, 224 rnm c. c.

594 I Zn

16 rnm c. c.
30L x 14W x 18H



528 I Zn

96 rnm c. c.



214IA1

32, 64, 96, 128, 160, 192mmc. c.

21SIA1

32, 64, 96, 128, 160, 192, 224, 320, 352rnm c. c.

216IA1

32, 64, 96, 128, 160, 192, 224, 320,
60, 300, 400mmc. c.



206IA1

32, 64, 96, 128, 160, 192, 224rnm c. c.
